

## ECCA LODGE



### LODGE & ACCOMMODATION OVERVIEW

Airy and open, **Eccca Lodge** invites guests to embrace an indoor–outdoor lifestyle that immerses them in the African wilderness. Each suite features wraparound wooden decks, private plunge pools, and outdoor showers—designed to enhance the connection with nature. Inside, guests are cocooned in comfort with super-king beds, spacious bathrooms, and individual lounge areas. There are six suites in total: **three Private Vehicle Suites**, each offering an exclusive safari experience with a dedicated vehicle, guide, and tracker, and **three Luxury Safari Double Suites**, set slightly apart for added privacy and sharing a safari vehicle with a guide and tracker.

| LODGE FACILITIES      |                               |
|-----------------------|-------------------------------|
| NUMBER OF SUITES      | 3 Double   3 Private Vehicle  |
| CHILDREN              | All ages welcome              |
| CHILD-MINDING         | ✓ No additional cost          |
| FENCED / PATROLLED    | ✓ Unseen fence                |
| CHECK-IN              | 13:00                         |
| CHECK-OUT             | 11:00                         |
| CREDIT CARDS          | ✓                             |
| VEHICLE & RANGER      | Open – up to 6 guests*        |
| MAXIMUM GUESTS        | 12 Adults & 6 Children        |
| ELECTRICITY           | 220V                          |
| INTERNATIONAL PLUG    | In hairdryer bag              |
| CONNECTIVITY          | Wi-Fi & limited cell service  |
| SWIMMING POOL         | Private plunge pool per suite |
| KEEP FIT              | Gym in a bag                  |
| SPA FACILITIES        | In-room treatments            |
| CURIO SHOP / BOUTIQUE | ✓                             |

| SUITE FACILITIES       |                       |
|------------------------|-----------------------|
| EXTRA BEDS             | ✗                     |
| AIR-CON                | ✓                     |
| FAN                    | ✓                     |
| PRIVATE POOL           | ✓ Pool nets available |
| MOSQUITO NETS          | ✗ Malaria free        |
| BATH                   | ✓                     |
| SHOWER                 | ✓ Indoor & Outdoor    |
| IN-ROOM SAFE           | ✓                     |
| DOUBLE VANITY          | ✓                     |
| COMPLIMENTARY MINI BAR | ✓                     |
| COFFEE & TEA STATION   | ✓                     |
| TELEPHONE              | ✓                     |
| HAIRDRYER              | ✓                     |
| LAUNDRY                | ✓                     |
| DISABLED ACCESS        | ✗                     |
| SQM                    | 78 m <sup>2</sup>     |

*\*A maximum of two children under 12 stay free in a Private Vehicle Suite, accommodated on daybeds (CCR Levy applies).  
Children under 12 are not permitted on shared safaris, which accommodate a maximum of six guests per vehicle.*



## ECCA LODGE

### LOCATION & ATMOSPHERE

**LANDSCAPE** Set in the heart of the Private Reserve in thick vegetation overlooking a secluded valley, Ecca Lodge offers breathtaking views of an escarpment of steep shale cliffs.

**FOOD** Savour the freshness of locally sourced ingredients, transformed into simple yet exquisite dishes. Indulge in culinary artistry that celebrates the region's flavors, from the deeply rich to the delightfully divine.

**FEELING** With just six suites—three Private Vehicle Suites and three Luxury Safari Double Suites—the lodge offers an intimate, relaxed atmosphere. The design reflects understated elegance, with natural tones and textures that blend seamlessly into the surrounding landscape.

**HIGHLIGHTS** Expansive wooden viewing decks with exceptional views and a rim-flow lap pool.

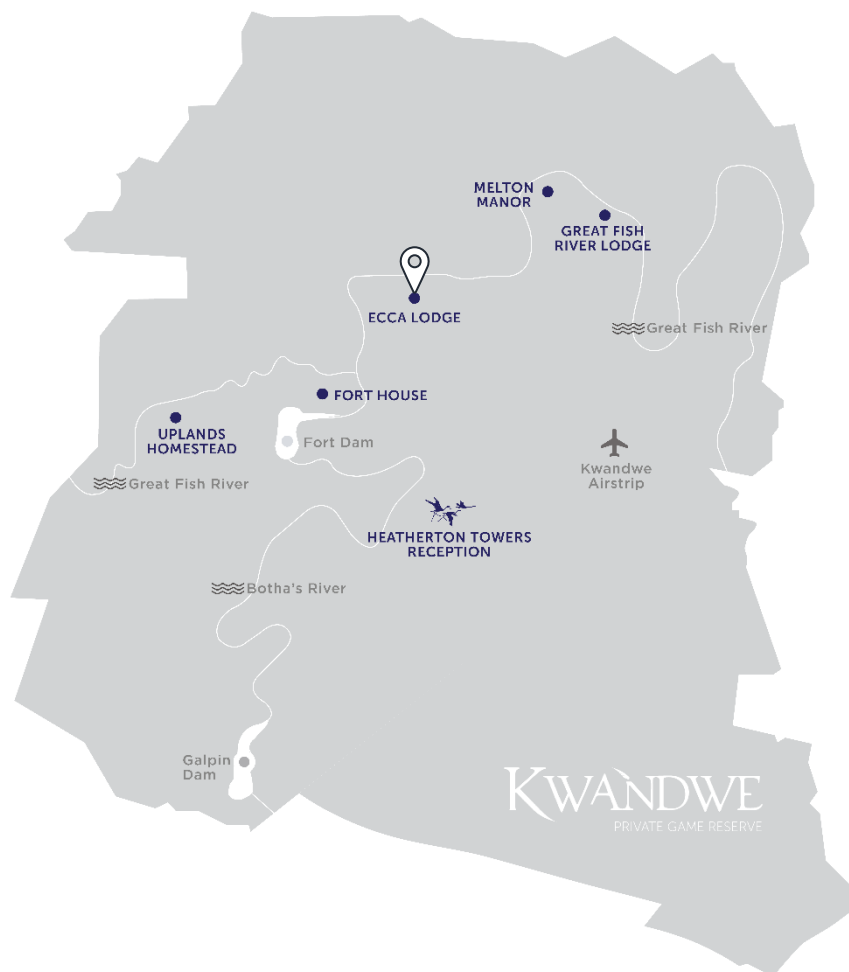

### EXPERIENCE KWANDWE PRIVATE GAME RESERVE

Fostering true connection with the land, wildlife, our communities and conservation is the foundation of our activities and experiences at Kwandwe Private Game Reserve. Take time to explore our 30'000 hectares of wilderness, hear the stories it holds close to her heart and share your #kwandwemoments with us.

#### ACTIVITIES AT ECCA LODGE

|                    |  |                                |                        |
|--------------------|--|--------------------------------|------------------------|
| GAME DRIVES        | ✓ Twice daily  | SPA TREATMENTS                 | ✓ In-room              |
| NATURE WALKS       | ✓ Pre-booking req   Accompanied by armed specialist ranger | CHILD-MINDING                  | ✓ No additional charge |
| BIG GAME WALKS     | ✓ Pre-booking req   Accompanied by armed specialist ranger | FAMILY-FRIENDLY LOUNGE WITH TV | ✓ Main lodge area      |
| VOLUNTOURISM       | ✓ Enquire  | CURIO SHOP / BOUTIQUE          | ✓ Main lodge area      |
| PRIVATE SAFARIS    | ✓ Enquire  | FISHING                        | ✓ Enquire              |
| SPECIALIST SAFARIS | ✓ Enquire  | FAMILY ACTIVITIES              | ✓ Enquire              |

**PLEASE NOTE:** All double rooms at Kwandwe Private Game Reserve can be made into twin beds on request. Enquire for special occasions, specialist safari experiences and special requests.



## ECCA LODGE

### LODGE LAYOUT

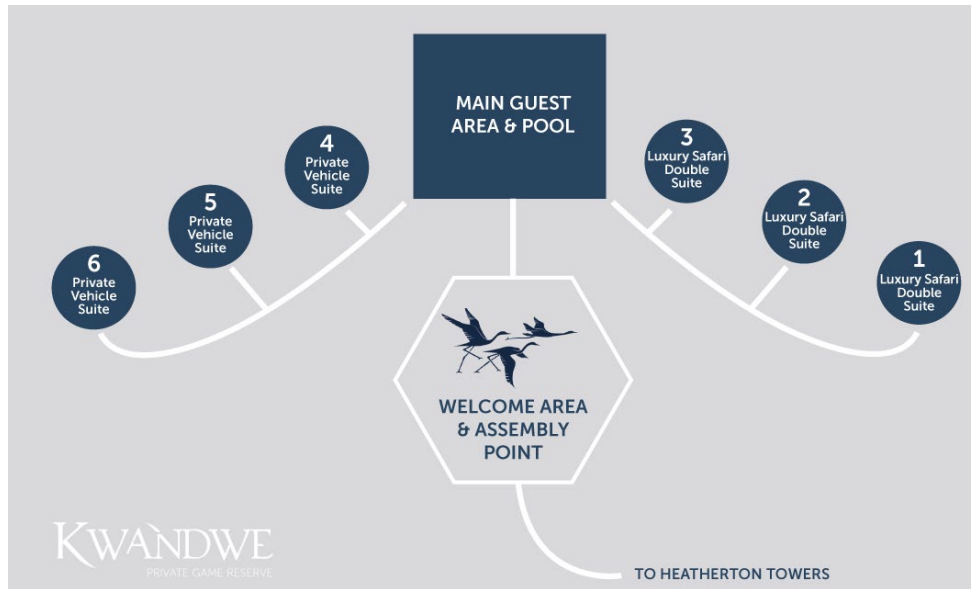

### LUXURY SAFARI DOUBLE SUITE LAYOUT

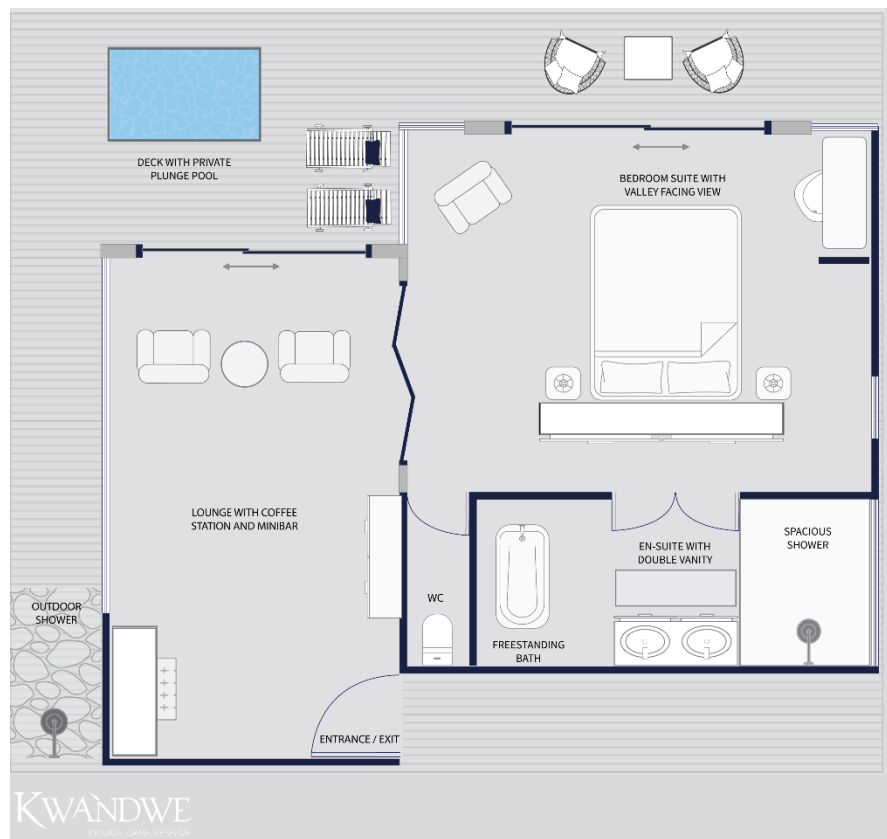

## ECCA LODGE

### PRIVATE VEHICLE SUITE LAYOUT

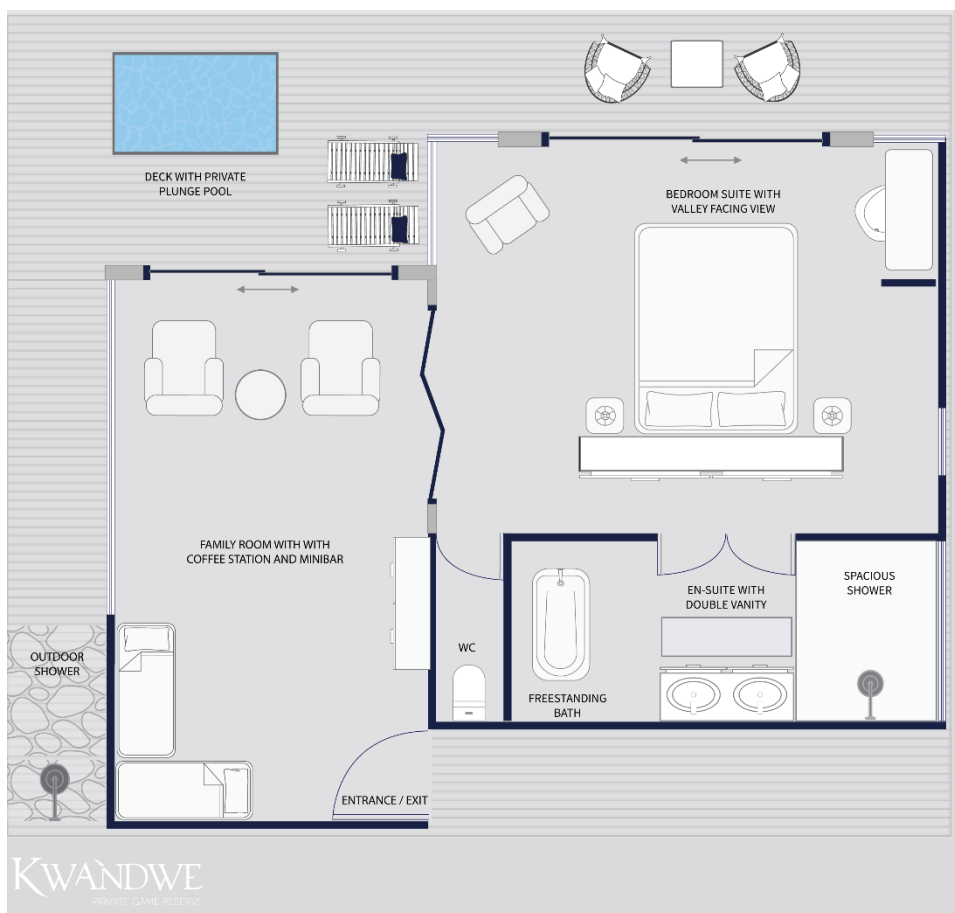

### ARRIVING AT KWANDWE PRIVATE GAME RESERVE

All guests arriving at Kwandwe Private Game Reserve are warmly welcomed at **HEATHERON TOWERS**, the reserve's reception and guest arrival point. This historic building marks the beginning of your Kwandwe experience, where our team will greet you before you continue your journey in a Kwandwe safari vehicle to your lodge. Please use the following GPS coordinates for your arrival: -33.145561581342236, 26.525272757172647.

EXPLORE | CONNECT | BE INSPIRED

DISCOVER SOMETHING NEW IN EVERY MOMENT

#KWANDWEMOMENTS

